

SUITABLE FOR RENTAL INVESTMENT AT THE HEART OF SISLI/ISTANBUL**\$365,000****Lot No:** 143**Bedrooms:** 2**Area (m2):** 48 - 115 m2**Bathrooms:** 1-2**Land Area (m2):** 7.000 m2**Number of Floors:** 5**Property Features;**

Sauna

Concierge

Appliances

Elevator

Signaling

Satellite TV

Park

Air Conditioning

Swimming Pool

Smart House

Parking

Description;

This project is being developed in Bomonti, the heart of Şişli. The project consists of 55 flats in 1+1 and 2+1 types and is ready for residence. The total area of the project, which has 11 flats on each 5 floors, is 1000 square meters, and the construction area is approximately 7,000 square meters. There is also a well-equipped fitness center in the housing project consisting of a single block.

As soon as you buy a house from this project, you will be able to get your title deed immediately. The project, located in the center of Istanbul, promises a comfortable life to its buyers with the opportunities it offers.

The project, which stands out with its proximity to business centers in Şişli, offers a brand new living space by significantly reducing the time between home and work. Holdings and companies in this region, which is located in the city center, are within walking distance of the project.

This region, which is the center of cultural and artistic activities in Istanbul, becomes indispensable for those who want to fully feel the texture of the city in their living spaces. Especially the entertainment venues in Bomonti will allow you to have a good time with your family and friends.

Known for its proximity to all central transportation networks such as Metrobus, metro, bus or minibus, Şişli Bomonti draws attention with its walking distance from central areas of Istanbul such as Taksim and Mecidiyeköy. Moreover, the project is 5 minutes from Nişantaşı, 6 minutes from Beşiktaş and 10 minutes from Ortaköy.

SUITABLE FOR RENTAL INVESTMENT AT THE HEART OF SISLI/ISTANBUL

\$365,000



SUITABLE FOR RENTAL INVESTMENT AT THE HEART OF SISLI/ISTANBUL

\$365,000



SUITABLE FOR RENTAL INVESTMENT AT THE HEART OF SISLI/ISTANBUL

\$365,000

6-17-28-39

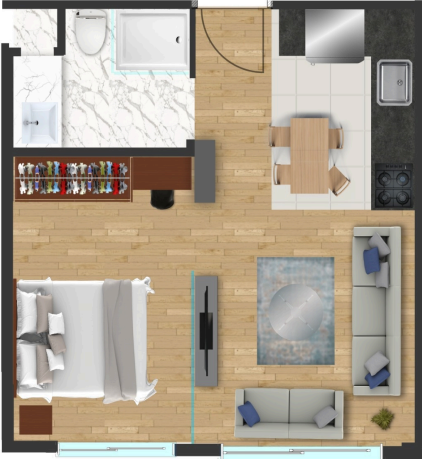

5-16-27-38



2-13-24-35

