

FAMILY CONCEPT PROJECT AND NEXT TO SEA IN KARTAL/ISTANBUL

\$221,000

Lot No: 997

Balconies: 1

Area (m2): 53 - 153 m2

Number of Floors: 22

Land Area (m2): 20.972 m2

Year of Construction: 2018

Bedrooms: 3

Distance to Sea: 4 KM

Bathrooms: 1-2

Distance to Airport: 70 KM

Property Features;

Sauna
Elevator
Park
Smart House

Concierge
Signaling
Air Conditioning
Parking

Appliances
Satellite TV
Swimming Pool
Balcony

Description;

This project, which will be realized by a reliable and strong construction company in Kartal, is built on a 20 thousand 972 square meter plot. The project, which has a construction area of 156 thousand square meters, has 825 flats and 17 commercial units. There are 1+1, 2+1, 3+1 and 4+1 flat types in the project.

The construction company, which has signed different projects in many points of Istanbul, plans to add a new one to its projects in Kartal. There are 825 residences and 17 commercial units in the project, which is expected to accommodate 2 thousand 44 people when completed. The project, which will consist of 10 blocks, will be built on the site of Yücel Sitesi, which is right next to the Kartal Courthouse. There will be housing options from 1+1 to 4+1 in the project. In the project, 1+1 apartments are between 46.74 square meters and 54.68 square meters, 2+1 apartments are between 76.63 m2 and 95.35 m2, 3+1 apartments are between 111.33 m2 and 132.16 m2, and 4+1 apartments are between 158,14 m2. Pre-sales of the project have already started. With the completion of the project, which will include 5 large parking areas, it is anticipated that the region will become one of the most social and striking projects of Kartal, thanks to the park areas.

In the project, which will include many activity areas from the outdoor swimming pool to the fitness center, from the sauna to the steam room, from children's playgrounds to multi-purpose sports areas, as social equipment, indoor and outdoor parking will be provided for the vehicles of the residents.



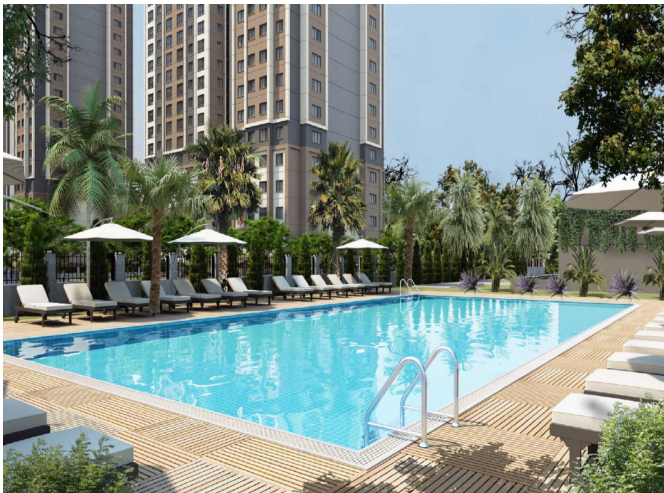

FAMILY CONCEPT PROJECT AND NEXT TO SEA IN KARTAL/ISTANBUL

\$221,000

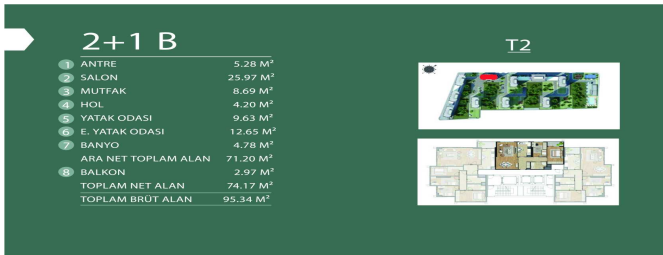
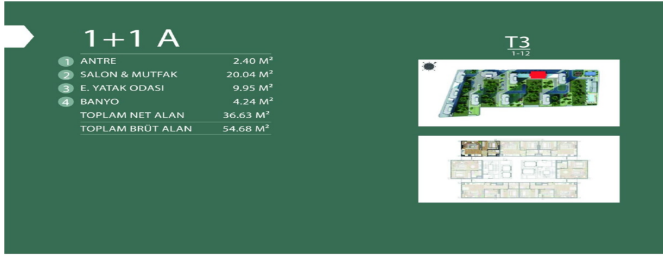

FAMILY CONCEPT PROJECT AND NEXT TO SEA IN KARTAL/ISTANBUL

\$221,000

